

## - Fold-Down Boat Lounge Seat Assembly -

### **HARDWARE:**

8 - ¾" long; ¼" x 20 Phil Truss Bolts (pre threaded into the cushion bottom upon arrival)

4 - 1" long; ¼" x 20 Phil Truss Bolts

4 - ¼" ID, 1" OD Fender Washers

**Tools Needed** – Phillips head screwdriver

### **- ASSEMBLY INSTRUCTIONS -**

#### LAY - DOWN SEAT

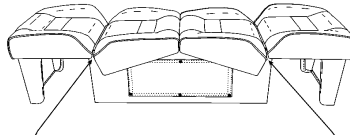

Lift at Cushion/Back junction to fold up seats.

**\*Thread each bolt in by hand to ensure that the t-nut is not pushed into the cushion. Tighten with screwdriver.**

1. Position the vinyl covered base box in place on your boat. (Ensure there is ample room on all sides for the seat cushion in the laydown position.) Use #14 lag screws (not provided) to secure the base box to your deck. Extend all four scissor hinges to prepare the base box for the cushion installation.

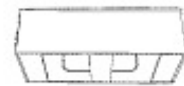

2. Unfold the cushion; remove the 8 pre-threaded bolts from the bottom of the seat and lay, upholstered side down, flat on the floor. (Will need bolts to connect hinges later)

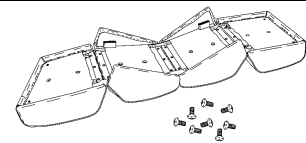

3. Place one leg on the end of the cushion. Make sure the wood triangle corner is flush with the cushion wood, making the vinyl covered side of the leg, facing outward. Line up the hole in the leg corner with the t-nut hole in the cushion. Place a washer on the 1" long – ¼" x 20 bolt, thread through the wood and into the t-nut in the cushion corner. Repeat on opposite side.

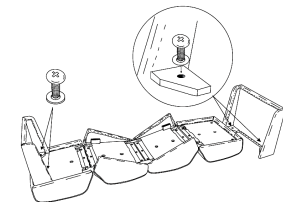

4. Position the seat cushion and newly installed legs upright on the base box (scissor hinges should be extended) in the laydown position.

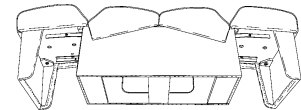

5. Line up the cushion t-nuts and scissor hinge holes and insert the ¾" long – ¼" x 20 bolts (removed at the beginning) and thread into t-nut until tight\*. Repeat on opposite side.

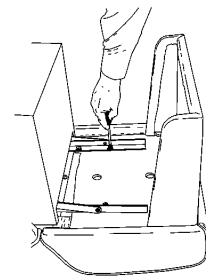

6. Installation complete! Enjoy the water!

#### LAY - DOWN SEAT

Installation of your lay-down seat into your boat must be done in accordance to the furniture layout of that boat. Veada Industries is not responsible for damages caused to your boat through the installation process.

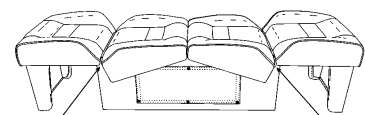

Lift at Cushion/Back junction to fold up seats.